

# Ad Hoc Solitaire

Antonio Citterio, 1994, 2010



## Ad Hoc Solitaire

The Ad Hoc office furniture system was designed in collaboration with Antonio Citterio in 1994 and has been continuously updated and expanded ever since. It is both an archetype and a classic in the area of office furniture systems. The functional longevity and economic efficiency of Ad Hoc are due to its adaptability, high-quality materials and superior workmanship, as well as its timeless expression of technological elegance.

Ad Hoc is highly versatile, making it suited to a broad range of applications. As a modular system, it can be configured to meet individual requirements – right down to the smallest details. With individual tables or groups of tables in various sizes, it also fulfils all standard office requirements. Ad Hoc High Work utilises different legs to provide new options for healthier standing work postures. Ad Hoc Executive offers elegant solutions for management, and Ad Hoc Solitaires complete the range with conference and visitor tables.

Ad Hoc Solitaires offer a selection of configurable conference and visitor tables that complement the related modular furniture system for workstations. Ad Hoc conference tables are available in various sizes, shapes and surface materials. They can be equipped with power and data connections and, like the workstations, are available in both sitting and standing heights. Equipped with glides or castors, the visitor tables serve as a practical addition in a wide range of settings – from small side tables in private offices up to multiple furnishings in large assembly halls.

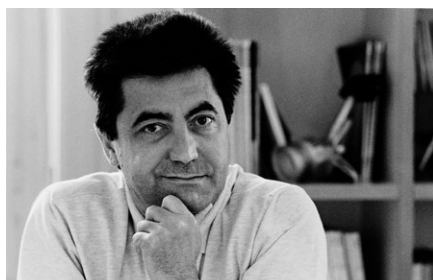

### Antonio Citterio

The architect and designer Antonio Citterio, who lives and works in Milan, has collaborated with Vitra since 1988. Together they have produced a series of office chairs and various office systems, as well as products for the Vitra Home Collection. The Citterio Collection is constantly being expanded.

1 Ad Hoc Solitaires  
2-3 Configurations  
4 Table tops

5-7 Dimensions,  
surfaces and colours



**Boat-shaped meeting table**, oak veneer top. Chairs: Skape

---



**Round meeting table**, polymer concrete table top with Aletta electrification flap. Chairs: AC4

---



**High rectangular meeting table**, melamine top in soft light. Chairs: Nelson Perch

---



**High rectangular meeting table**, melamine top in soft light with Flap electrification unit. Chairs: .03 High

---



**Rectangular visitor table**, equipped with castors. Chairs: Unix

---

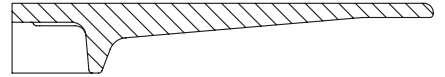
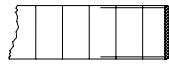
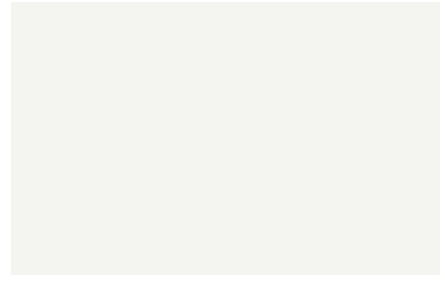
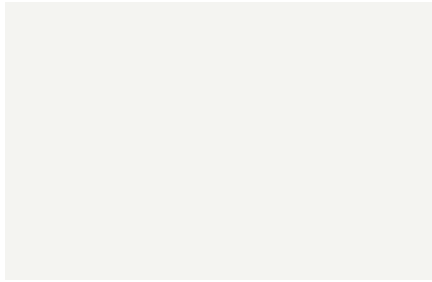

**Melamine, soft light**

Table top with melamine resin coating,  
ABS edge 3 mm, table thickness 25 mm

**Light oak veneer**

Table top in light oak veneer, wood veneer  
edge 2.5 - 3 mm, table thickness 25 mm

**White polymer concrete**

Table top in white polymer concrete, fully  
tapered edge with integrated collar

**DIMENSIONS**

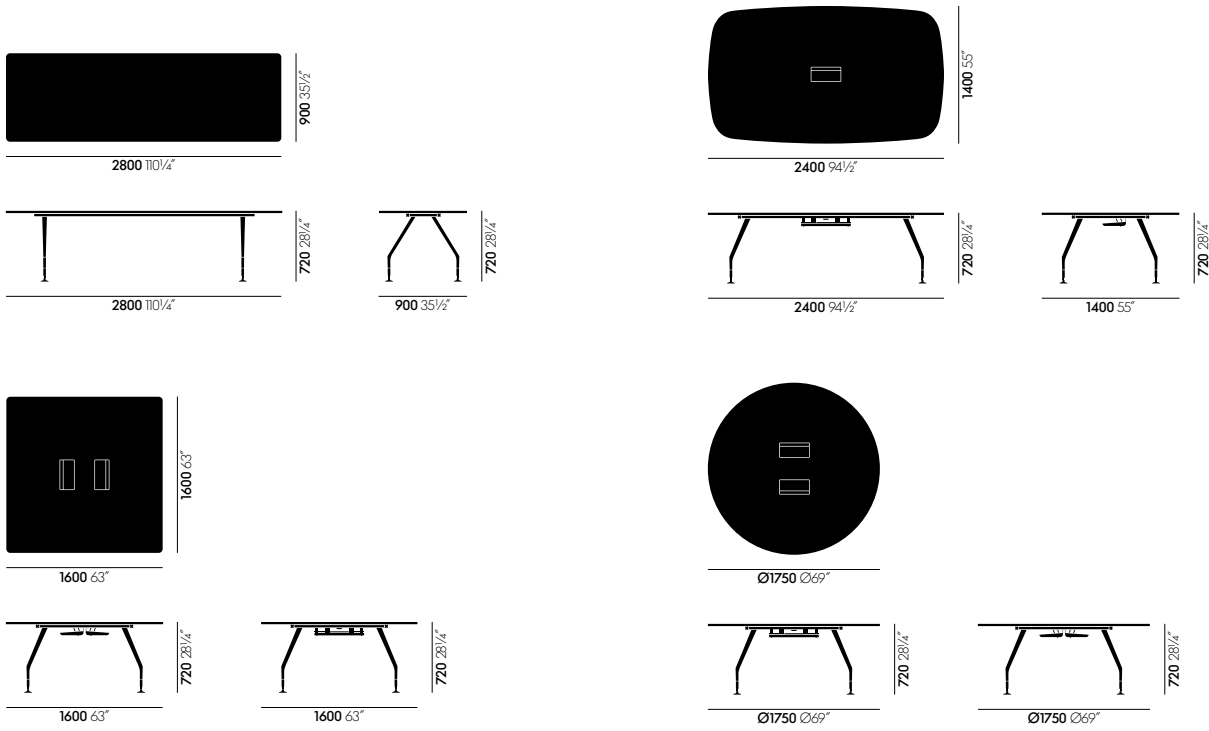

**Meeting tables**

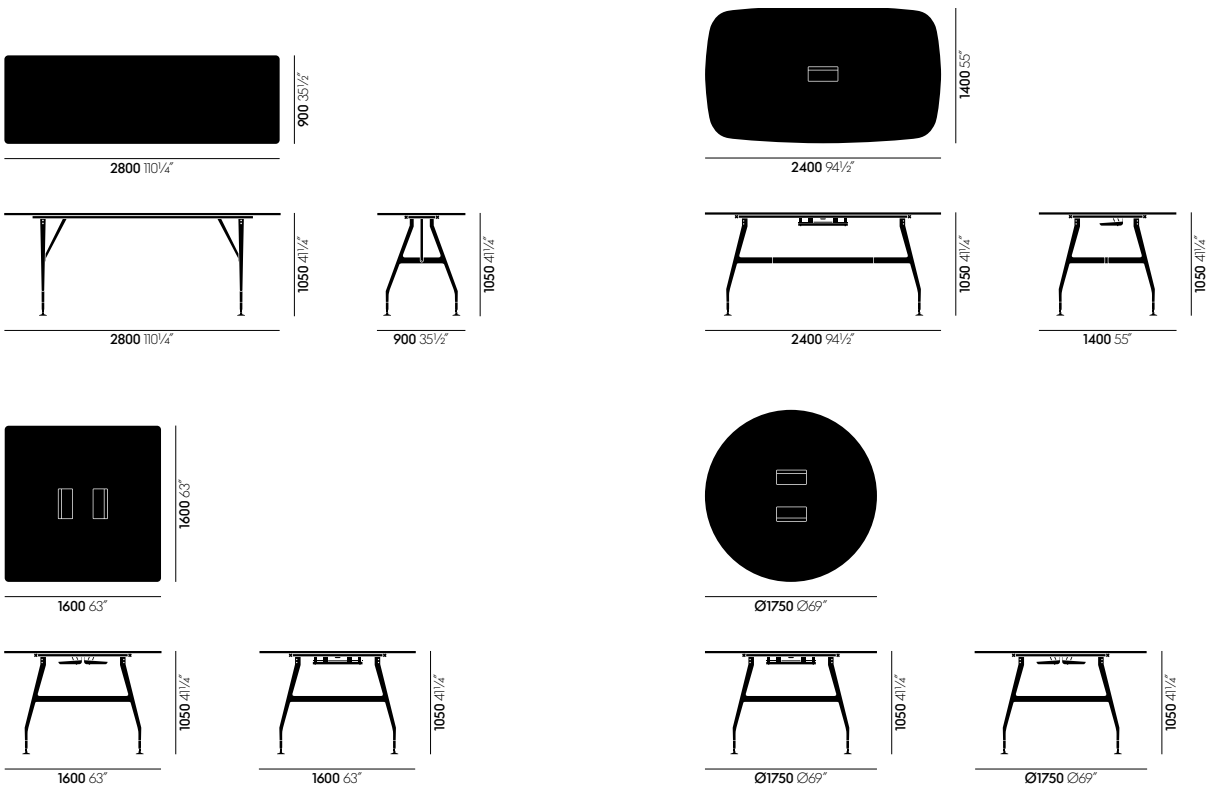

**High meeting tables**

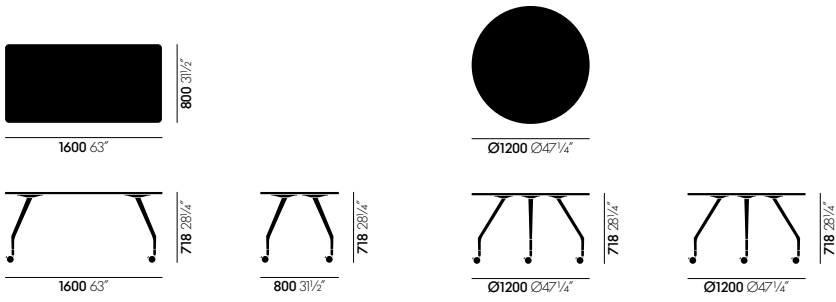

Visitor tables

SURFACES AND COLOURS

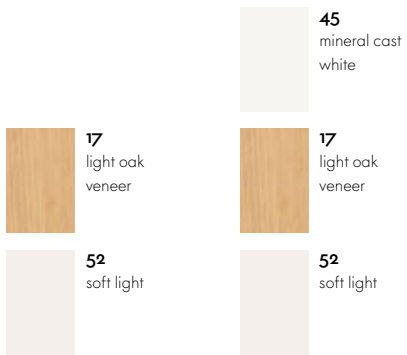

Table tops,  
visitor tables

Table tops,  
meeting tables





The Vitra Configuration System (VCS) software contains comprehensive information on all Vitra products and assists you in the preparation of plans and offers. Available from your Vitra sales representative or at: [vcs@vitra.com](mailto:vcs@vitra.com).

Planning data, further information and illustrations can be found on the Vitra extranet for architects: [www.vitra.com/extranet](http://www.vitra.com/extranet). For exact colour specifications, please order the Vitra Colour and Material Sample Box.

